

**PHASE II
KAMALI'I ALAYNA SUBDIVISION**

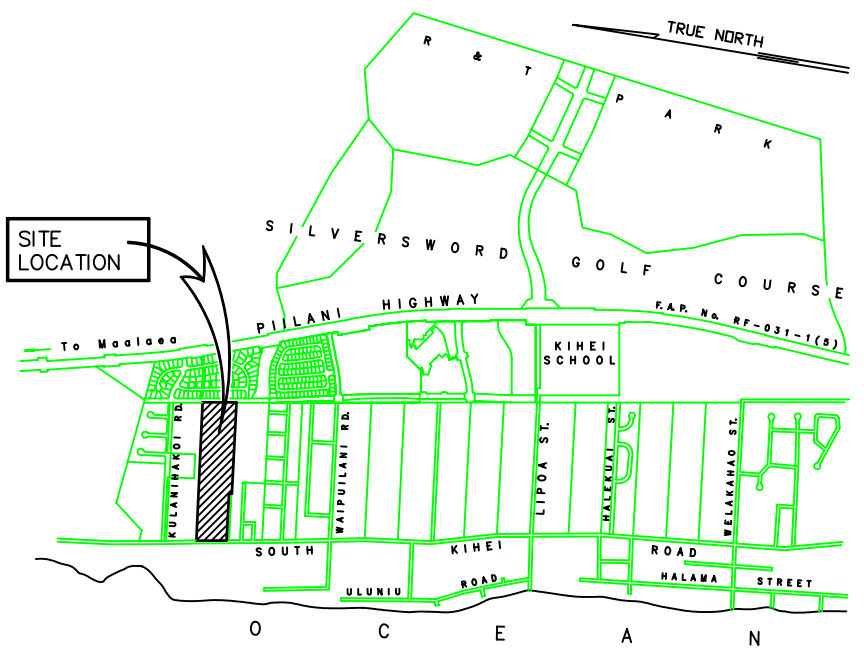

**LOT 24
5,860 Sq.Ft.**

FLOOD ZONE A3

ALL GRADES
REFER TO:
NGVD 1929

ZONING A3
BASE FLOOD
ELEV. = 9.68

HATCHED AREA
INDICATED 225 SQ.FT.
MINIMUM 10' WIDE
YARD REQUIREMENT

PROPOSED ONE
STORY DWELLING
MODEL B
(mirrored)

ELECTRICAL
EASEMENT

CONCRETE
DRIVE WAY
734 SQ. FT.

ROLLED CURB,
SIDEWALK AND
APPROACH TO BE
IN COMPLIANCE
W/ R-7 DETAIL

- Ⓢ = CABLE
- ⓔ = ELECTRIC
- Ⓣ = TELEPHONE
- Ⓢ = SEWER
- Ⓦ = WATER

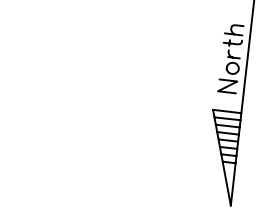
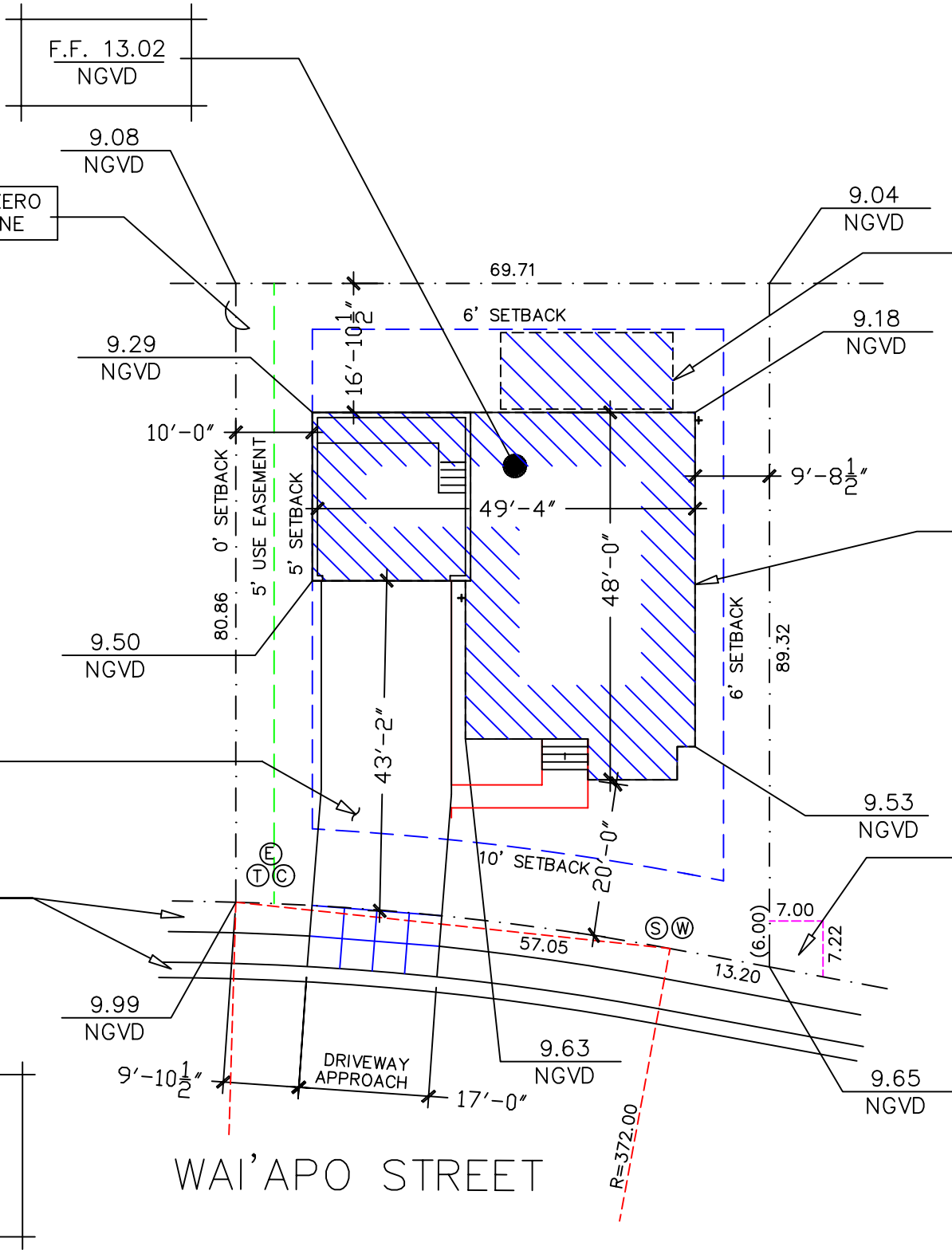

SITE PLAN
Scale 1"=20'-0"

ONE STORY
MODEL B (mirrored)
FILE PLAN: Lot 24
TMK: (2) 3-9-001:009
Lot Size: 5,860 Sq.Ft.
Date 2-5-07
Buyer's Signature
Buyer's Signature
Date

NGVD = National Geodetic Vertical Datum

Kamali'i Alayna Subdivision
Kihei Maui Hawaii

PLOT PLAN FOR: BETSILL BROTHERS SPEC

Architect's Note: This work was prepared by me or under my supervision. Construction of this project will be under my observation. (Observation as defined by the Board of Professional Engineers, Architects and Surveyors of the State of Hawaii.)

Notice: These plot plans were developed for pre-construction use and do not represent a specific house AS BUILT on a specific lot. A buyer utilizing these plans accepts them with full knowledge that they do not represent AS BUILT drawings and are useful as a general guide only. Developers reserve the right to make any changes they deem required.